

Installation Manual and Programming Guide

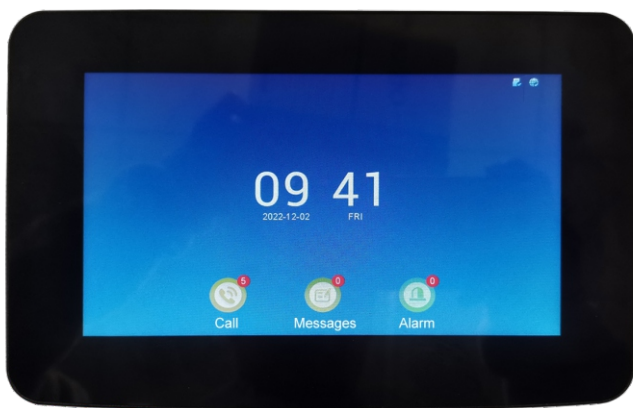

VIDEO INTERCOM SYSTEM
Indoor Smart Monitor with Tuya app

Table of Contents

Set-Up/Installation

Part and functions.....2
DIP switches.....2
Monitor.....2

Using Your Intercom

Main interface.....4
Intercom interface.....5
Parameter settings..... 5-10
Network configuration..... 10-12

Product introductions

- (1) Indoor monitor adopts multi-point capacitance touch screen, which is more stable and easier to operate.
- (2) 7-inch HD digital monitor with photo, video, visitor records and calendar functions.
- (3) Indoor monitor can manually and automatically take pictures, message function, ring back, the maximum support is 64G TF card.
- (4) Indoor monitor with monitoring, intercom, unlocking, photo-taking or video playback.
- (5) Volume, brightness, contrast and color adjustable, lock-in latency adjustment, multilingual OSD menu, the system supports 6 different languages: English, Russian, French, Spanish, German and Simplified Chinese
- (6) The indoor monitor can support the connection to five mobile phone APP users, and those mobile phone can monitor and unlock, and it can also support the communication between visitors and users of the Tuya Smart APP, which means you can talk to them anytime and anywhere.
- (7) The indoor monitor can be connected to the wireless WIFI.
- (8) The mobile phone APP can manually take photos, video recording and unlock functions.
- (9) Equipped with power supply and terminal cable, users can install it by themselves.

Note: Features and accessories are different for different outdoor unit types.

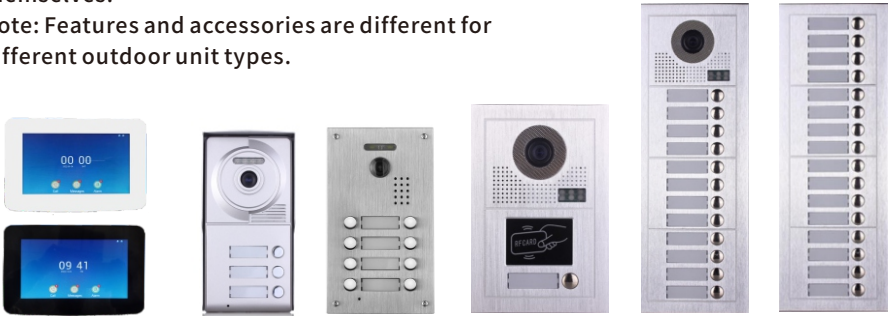



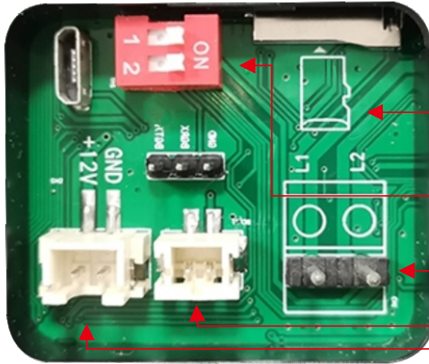

Parts and functions



2. Functional description

- (1) Bus interface.
- (2) TF card socket.
- (3) Video matching switch.
- (4) Bell-ringing interface.
- (5) 12V additional power supply

DIP switches

Bit state	Setting	Bit state	Setting
	Monitor at the end of the line		Reserved
	Monitor NOT at the end of the line		Reserved

Monitor mounting

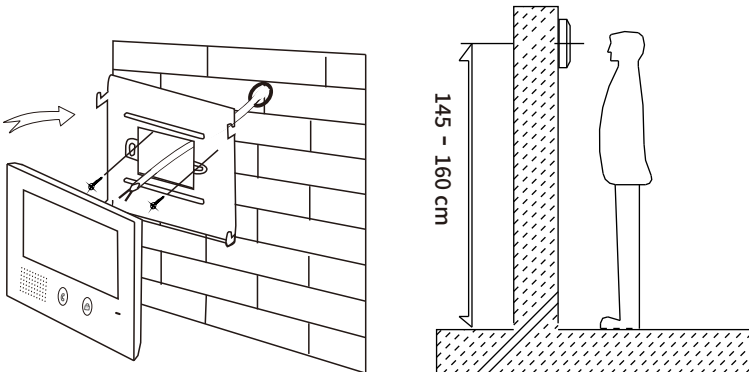

1. Using the screws to fix the mounting bracket on the wall.
2. Connecting the system correctly, then hang the monitor on the mounting bracket firmly.

Diagram of the video intercom

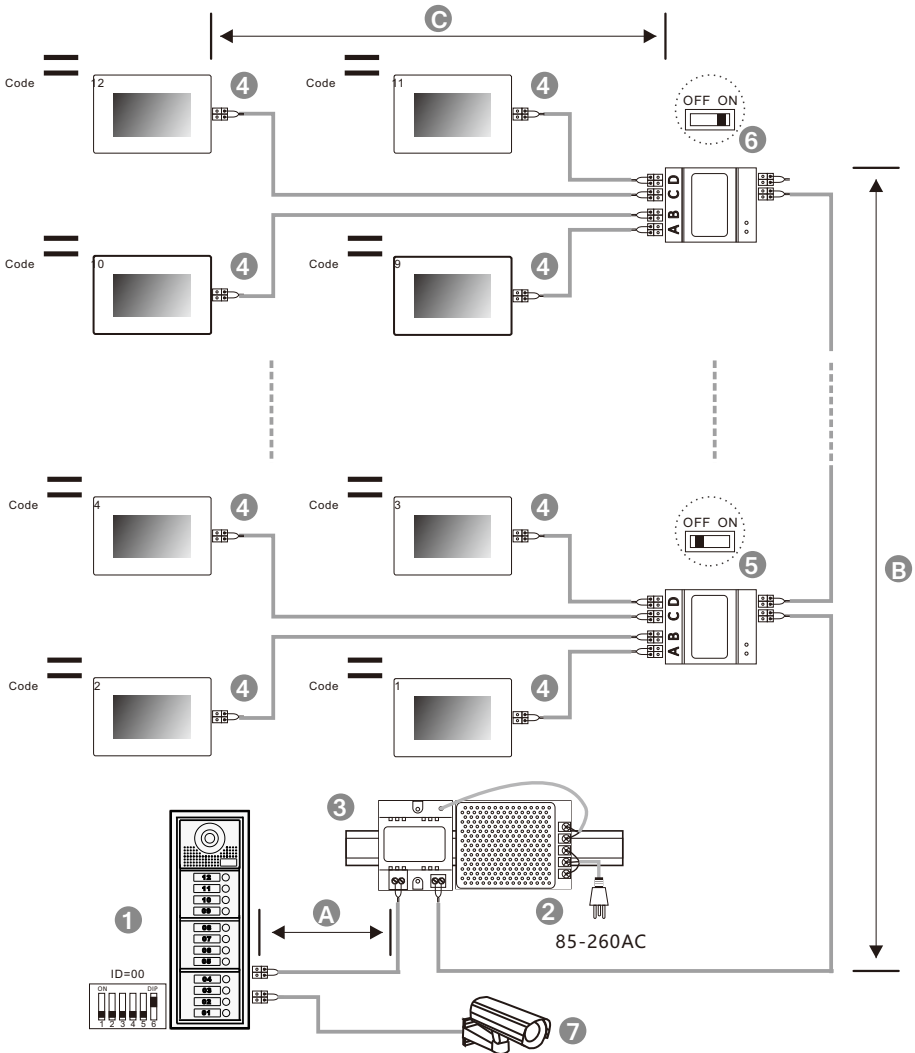

When monitor quantity < 20

CableUsage	A	B	C
Parallelcable2x0.75mm ²	60	60	30
Parallelcable2x1mm ²	80	80	40

When monitor quantity > 20

CableUsage	A	B	C
Parallelcable2x1mm ²	60	60	30
Parallelcable2x1.5mm ²	80	80	40

Main interface, time display and messages reminder. Time updates automatically after the device is connected to the network.

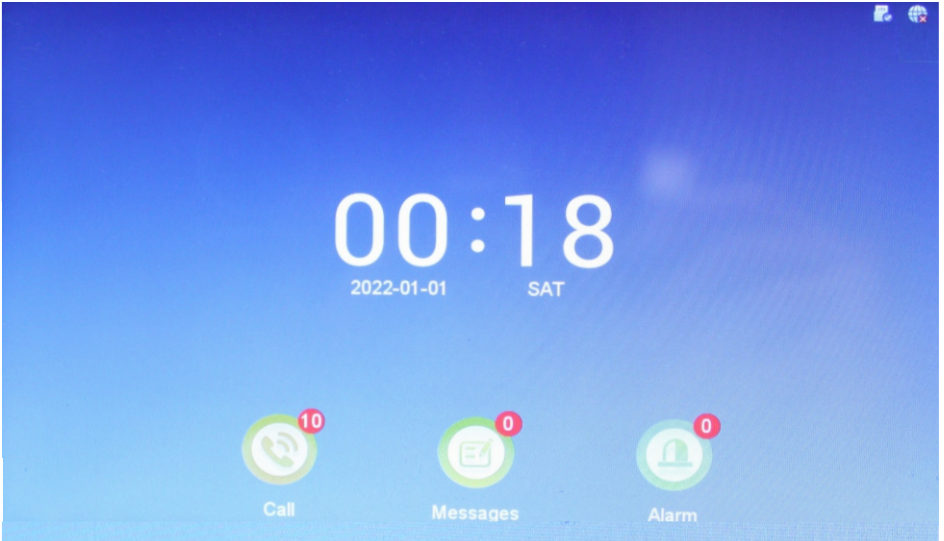

List of call video information. Record videos of each call and look back at any time.

Call	1/2
20221202095016_0019_Door1 .mov	Readed
20221202094955_0018_Door1 .mov	Unread
20221202094930_0001_Door1 .jpg	Unread
20221202094906_0026_Door1 .mov	Unread
20221202094140_0004_Door1 .mov	Readed
20221202094131_0004_Door1 .mov	Readed
20221202094049_0039_Door1 .mov	Unread
20221202094040_0004_Door1 .mov	Unread
20220101080043_0007_Door1 .mov	Unread
20220101000343_0009_Door1 .mov	Unread

Function interface selection. Monitoring, internal calls, message records, system settings and at the time state.

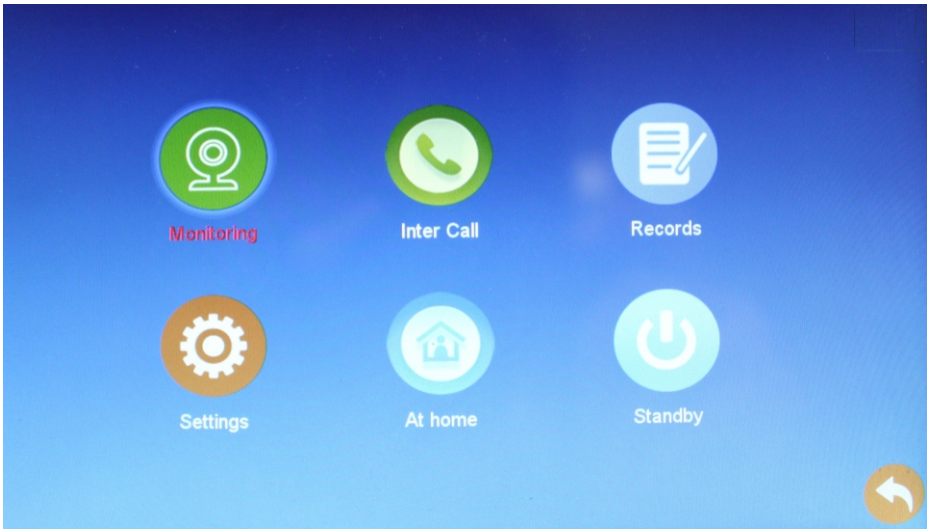

Monitoring function. Select door station 1, door station 2, external camera 1, external camera 2.



Internal call function. Enter the room number and press "#" to call.

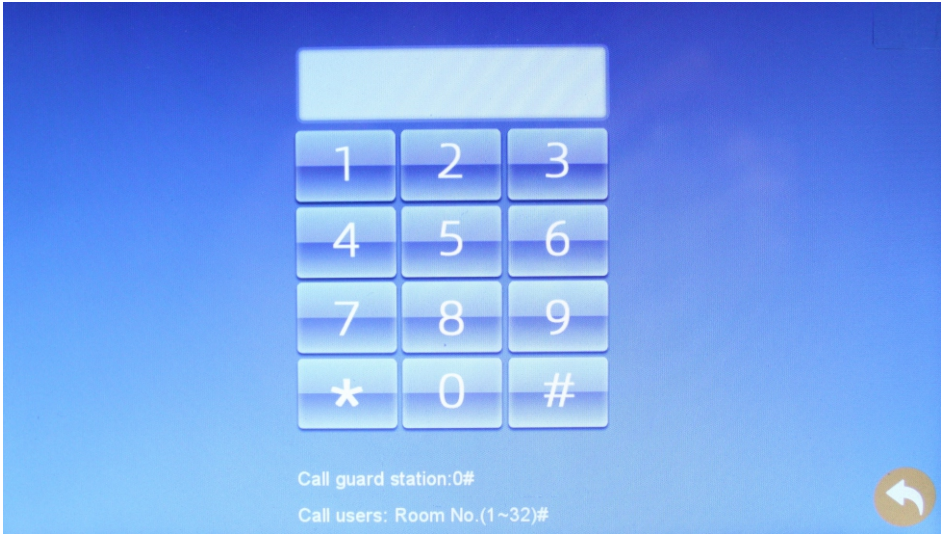

Check the information records

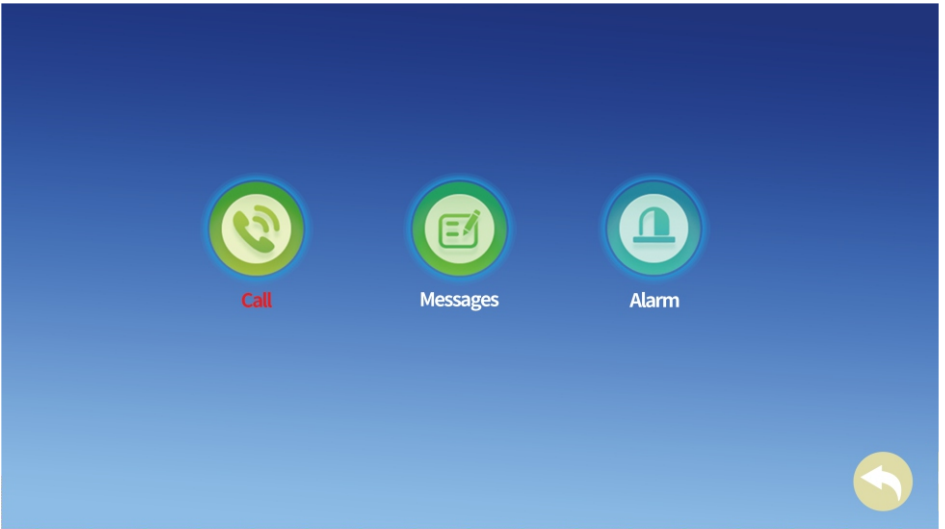

Current Device Status:

At home

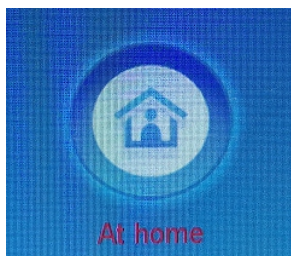

Not at home

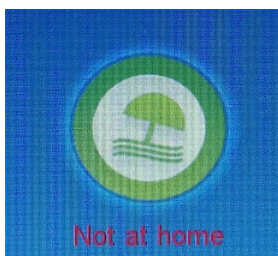

Dormant



Intercom interface, answer the call, hang up the call, unlock, take photos and other functions.



Parameter settings

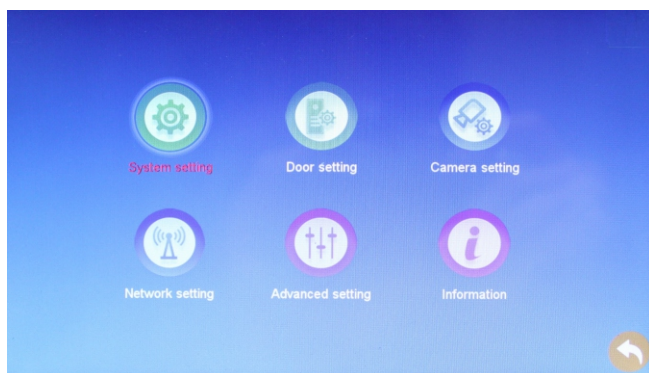

System setting: Device ID, Time, Date Format, Standby Clock, Language, Keypad tone and auto unlock.

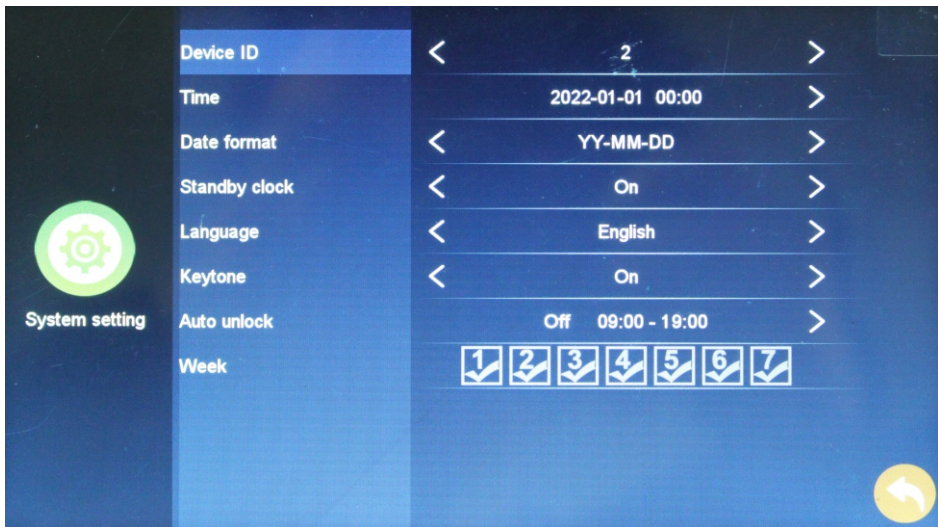

Door station parameter settings. Set the parameters of the door stations and the bell ringing tones.

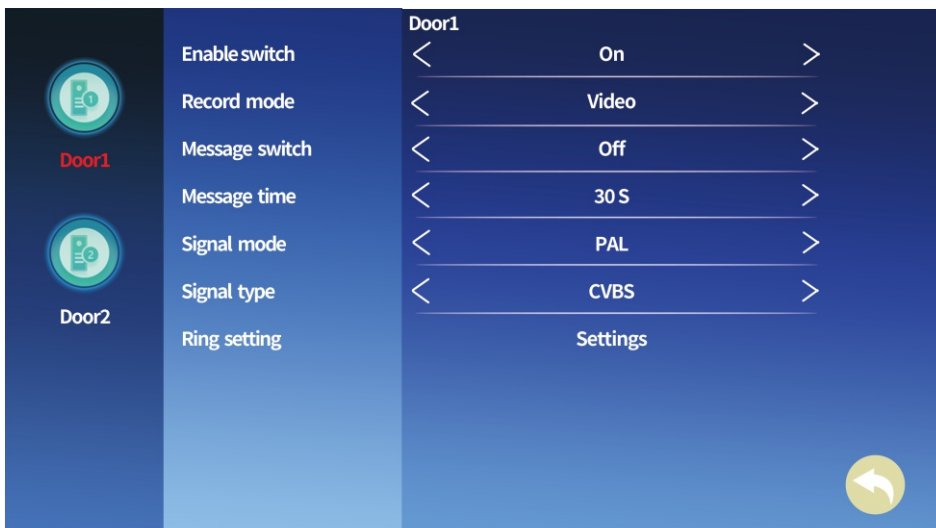

Ring settings.



The screenshot shows a settings menu for Ring devices. On the left, there are three circular icons representing Ring1, Ring2, and Ring3. The Ring1 icon is highlighted in red. The main settings area is titled 'Door1/Ring1' and contains the following options:

Setting	Value
Schedule	06:00 - 00:00
Time	30 S
Ring mode	Standard
Ring select	2
Ring volume	10

A yellow circular arrow icon is located in the bottom right corner of the settings area.

Camera' s paramter setting.

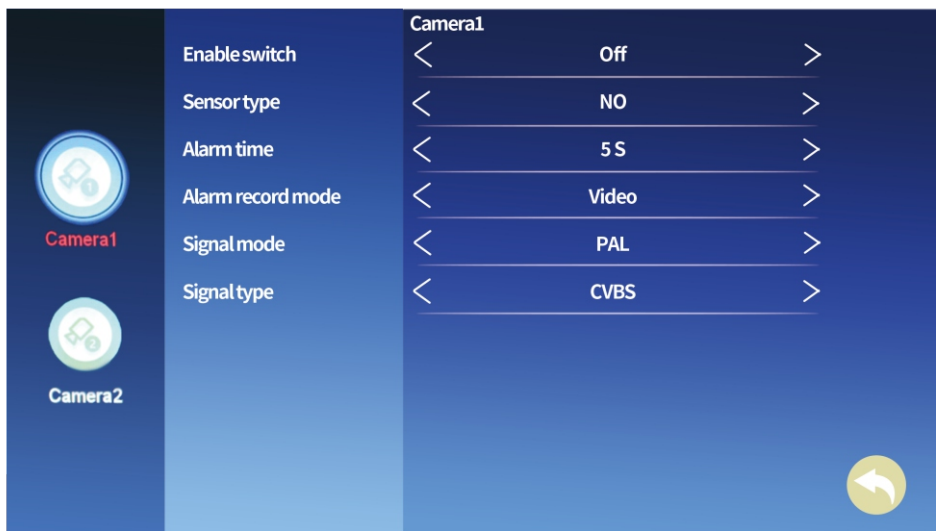

The screenshot shows a settings menu for Camera parameters. On the left, there are two circular icons representing Camera1 and Camera2. The Camera1 icon is highlighted in red. The main settings area is titled 'Camera1' and contains the following options:

Setting	Value
Enable switch	Off
Sensor type	NO
Alarm time	5 S
Alarm record mode	Video
Signal mode	PAL
Signal type	CVBS

A yellow circular arrow icon is located in the bottom right corner of the settings area.

The WIFI network settings. Select AP MODE and ZE MODE to restart system to take effect. Under AP MODE, the default WIFI password is

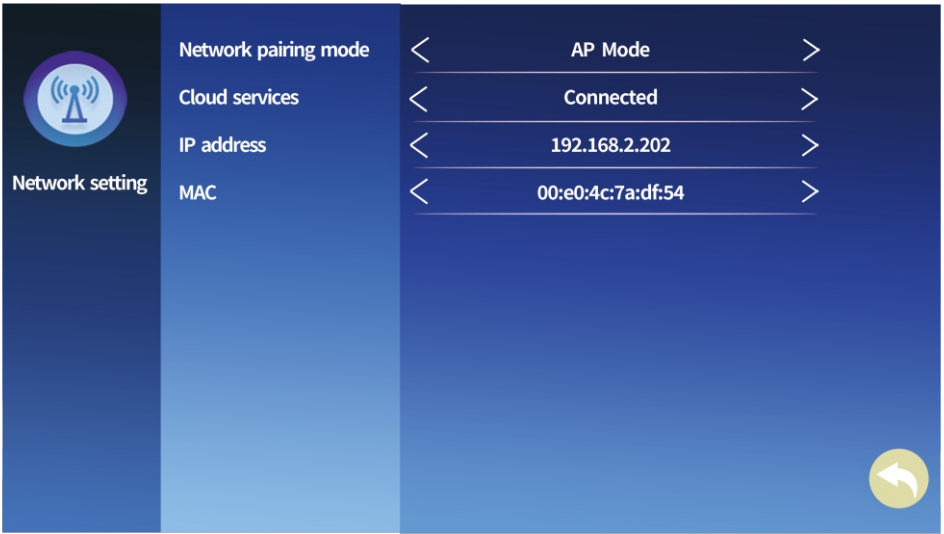

Advanced setting. Format the SD card, restore the original factory setup, the software update, and restart the system.

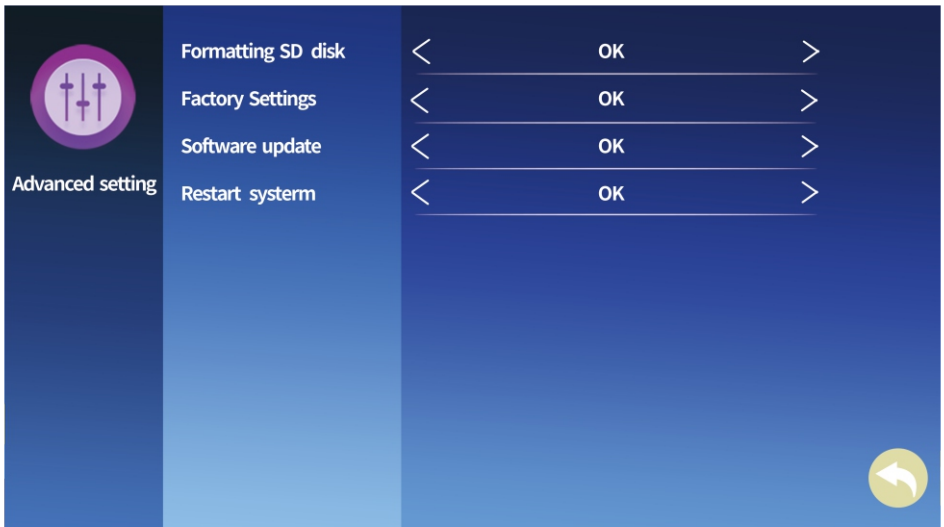

Check the device information, each device has a unique Tuya ID.

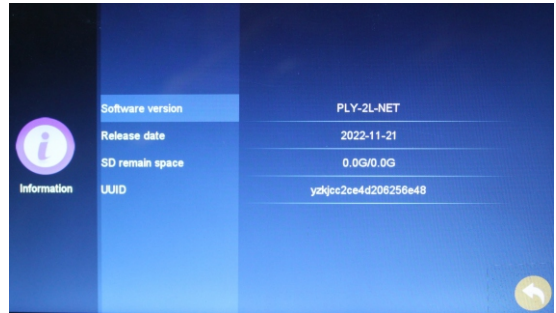

Indoor Monitor's network configuration :

(1) Overview:

The third-party cloud service used in this product is "Tuya Smart", which supports two network configuration modes, WIFI fast connection mode and WIFI AP mode.

(2) Steps of configuration network:

First, download the "Tuya Smart" APP in the application market and register your account.

Step 1: click the corresponding configuration network mode on the machine, setting--network setting--configuration network mode (note: switching the configuration network mode needs to be restarted);

Step 2: After selecting the configuration network mode, then to select the corresponding distribution network mode on the APP and enter the configuration network;

WIFI AP mode device select "AP mode", WIFI fast connection mode device selection "ZE mode"

Configuration network of WIFI fast connection:

- 1) Mobile phone is first connected to the WIFI network (2.4G);
- 2) Select "ZE mode" on the machine (the default);
- 3) Click "Tuya Smart" APP, add equipment - - security sensing - - smart camera - - select "WI_FL mode" in the upper right corner -- enter the user name and password of the current WIFI network - - start the network configuration - configuration done - - complete.

Specific operation progress of WIFI AP mode:(WIFI AP mode configuration network is recommended)

Click Tuya Smart APP

Specific operation process of WIFI AP mode: (WIFI AP mode configuration network is recommended)

Click Tuya Smart APP

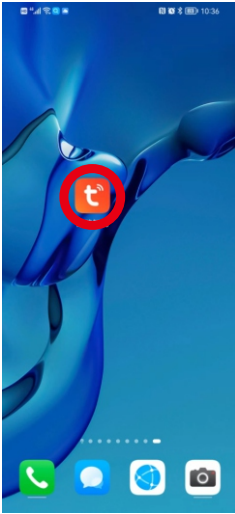

Add Device

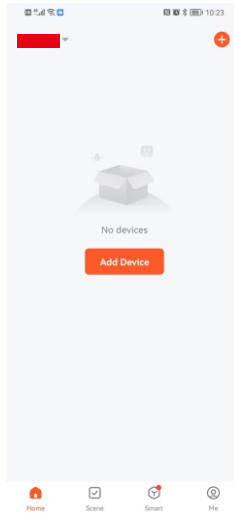

Select Camera & lock, double click Smart Camera(WiFi)

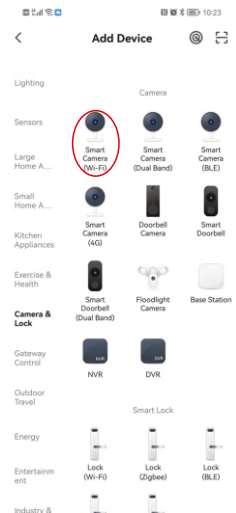

Selection WiFi mode to configure network

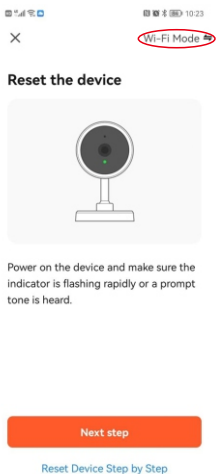

AP MODE
Select AP MODE

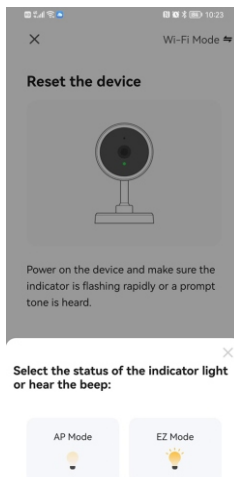

AP MODE Select
AP MODE



Select SmartLife-3a546f Monitor
WIFI,initial passwork is 12345678

Back to app homepage
waiting for connection

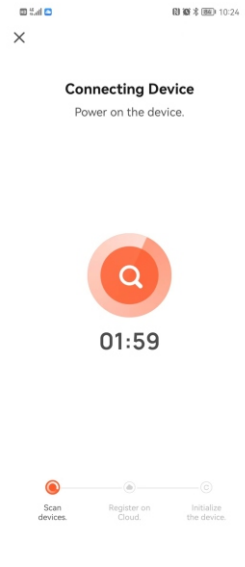
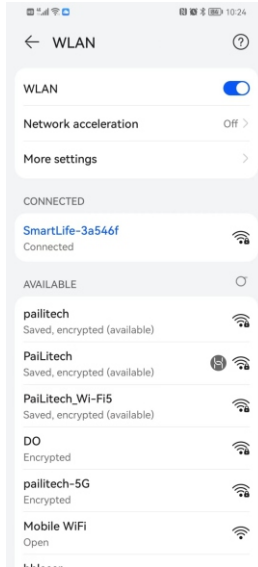
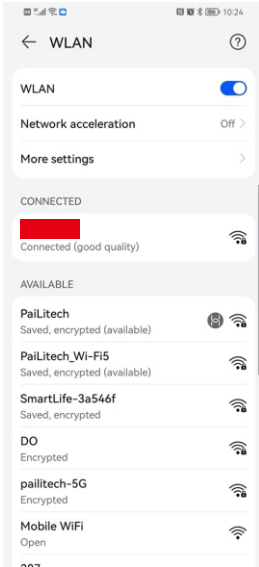

Add device successfully Call Operation

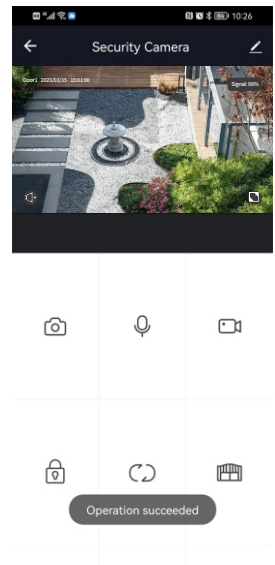
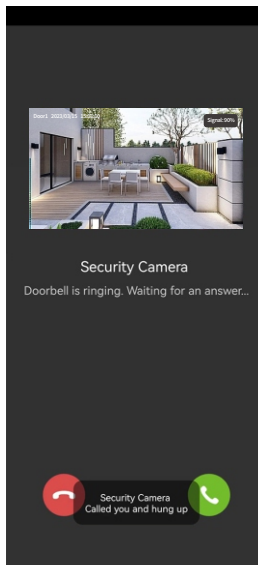
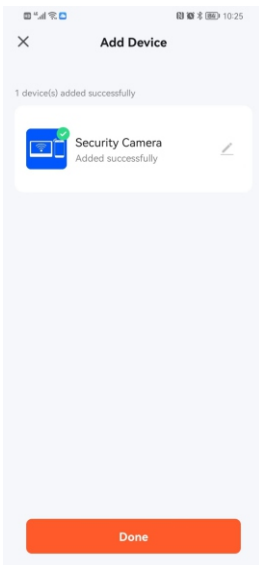



Product Technical Parameters

Bus power supply:	DC24V
External auxiliary power supply:	DC12V
Operation current:	24V--500mA
Standy current:	24V--150mA
Operation temperature:	-20 °Cto+55°C

