







Parts and Functions

How to setup the dial number on the monitor?

Keep pressing  button until you hear a long beep. Start setting 2 digit dial number.



 button refers to first digit 1~9 .  button refers to 0 / confirm.

Eg. Set the dial number to 09,press  (Long beep) – press  – press  9 times – press  .

Set the dial number to 10.

press  (Long beep) – press  1 time – press  – press .

Set the dial number to 12.

press  (Long beep) – press  1 times – press  press  2 times -press .

How to change the ring tone?

Keep pressing  button until you hear a long beep, current ring tone will be displayed.

There are 9 ring tones to choose from, press  button to choose the ring tone you want.

Press  button again to save and exit.

User Codes (Monitor bit codes) Setup

Every room station must have an **ID**, set through the bit codes(list right)

Bit-1 to Bit-5 are used to configure the room **ID**.

Bit-6 is the line-terminal switch, set the **LAST** monitor to **ON**, otherwise set **OFF**.

You can have a Max of 4 monitor per button/code.



Monitor NOT at the end of the line

Monitor at the end of the line

Bit state	User Code	Bit state	User Code	Bit state	User Code	Bit state	User Code	Bit state	User Code	Bit state	User Code
	Code=1		Code=7		Code=12		Code=18		Code=24		Code=30
	Code=2		Code=8		Code=13		Code=19		Code=25		Code=31
	Code=3		Code=9		Code=14		Code=20		Code=26		Code=32
	Code=4		Code=10		Code=15		Code=21		Code=27		
	Code=5		Code=11		Code=16		Code=22		Code=28		
	Code=6		Code=12		Code=17		Code=23		Code=29		

Power supply:

DC 24V (supplied by adaptor)

Power consumption:

Standby 15mA, working 350mA

Picture memory:

240pcs

Wiring:

2 wires, non-polarity

Video Intercom Systems User Guide and System Instructions

Getting Started

Congratulations on your new Video Intercom System! we are proud to provide secure, reliable entry solutions for your home or business. This user manual will provide answers for any operational questions you may encounter throughout your system's lifetime.



Door Entry

The outdoor panel for your system has been installed and programmed to ring your unit when the corresponding button is pressed. If your panel is equipped with an RF Card Reader, swipe the card/key-fob across the reader and the door will unlock.



Video Monitor Functions

The indoor room station has four illuminated buttons on the face and three scrolling adjusters on the edge to control Brightness, Color, and Volume.

The blue illuminated buttons from left to right are **Monitor**, **Alarm**, **Unlock**, and **Talk/Listen**.

To answer an incoming call, press **Talk** to answer, then speak freely. Calls last for 60 seconds - you DO NOT have to hold talk to enable voice communication. Press talk again to end the conversation. To **Unlock** the door, press the unlock button during a call and the door should release to allow entry.

Press **Monitor** button while in standby mode and you will be able to view the outdoor station camera. If there is an additional surveillance camera, press **Monitor** button again to switch modes. Press **Talk** twice to exit.

To change the Ringtone, press and hold Talk until you hear your current ringtone, then **Alarm** or **Monitor** to cycle through the different tones, then press **Talk** to save. There are 6 ring tones to choose.

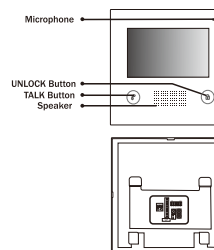

Parts and Functions

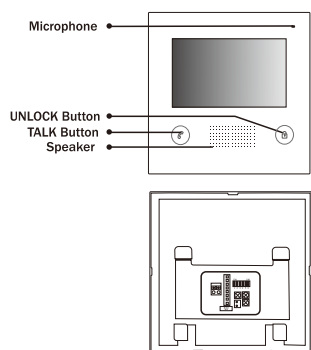

Basic Wringing (With IP module)

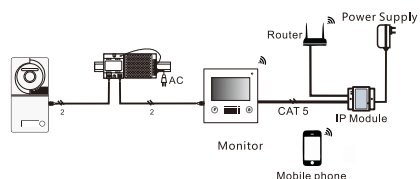

Monitor Mounting

Using the screws to fix the Mounting Bracket on the wall. Connecting the system correctly, then hang the Monitor on the mounting bracket firmly

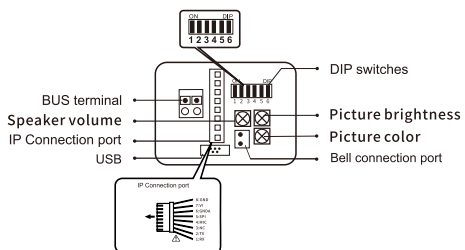
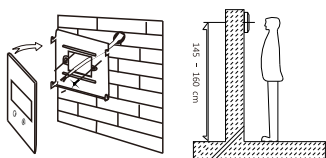

Operation Instructions

Answering a door call

Press CALL button on door station, the monitor rings, the visitor can be seen on the monitor screen. If nobody answers the call, the screen will automatically turn off in 30 seconds.

To answer an incoming call, press to answer, calls last for 90 seconds - Press again to end the conversation. If the system connects with two or more monitors, answering any monitor, the others will turn off automatically.

If there is an extra camera, during and incoming call, keep pressing switch to see the view of extra camera.

Parts and Functions

Door Release

During the conversation with the visitor, press button to unlock the door.

Monitoring

Keep pressing button while in standby mode you will be able to see the view of outdoor station camera. Keep pressing button to switch between door station and extra camera. (firstly you should have finish setting door station camera and extra camera, see below).

How to set door station camera and extra camera?

Keep pressing and button until you hear a long beep. Start setting state of multiple door station and extra camera. Press as many times as the quantity of specific code of door state.

For example :

There are 3 door stations, 2 door station with extra camera, specific code of door state is 8.

Keep pressing and (Long beep) – press 8 time- press .

There are 1 door stations, 0 door station with extra camera, specific code of door state is 1.

Keep pressing and (Long beep) – press 1time - press .

The form of the special code of the door state is as follows:

Door state	Specific code	Door state	Specific code	Door state	Specific code	Door state	Specific code
1 Door 0 Cam	Code=1	2 Door 2 Cam	Code=5	3 Door 3 Cam	Code=9	4 Door 3 Cam	Code=13
1 Door 1 Cam	Code=2	3 Door 0 Cam	Code=6	4 Door 0 Cam	Code=10	4 Door 4 Cam	Code=14
2 Door 0 Cam	Code=3	3 Door 1 Cam	Code=7	4 Door 1 Cam	Code=11		
2 Door 1 Cam	Code=4	3 Door 2 Cam	Code=8	4 Door 2 Cam	Code=12		

Inner Call

User can call other apartments by pressing button. To start the Inner call, first you need to setup a dial number on the monitor.